

ENERGY EFFICIENCY

Thermal transmission coefficient

$U_w = 1,58 \text{ W/m}^2\text{k}^*$

U_f profiles = 3,3 $\text{W/m}^2\text{k}$

Según EN10077-02 Balconera 1,2x2,4 mts

Vidrio $U_g = 1,1 \text{ W/m}^2\text{K} / \psi_g = 0,053 \text{ (W/mk)}$

Estimated acoustic performance up to R_w 40dB

Window size: 1.23m x 1.45m with acoustic laminated glass of 4+4.1A/
CAM/4+4.1A

TEST RESULTS

Protection against meteorological agents

Air permeability: **4**

Water tightness: **Window 6A - Balcony door 7A**

Wind resistance: **Window C5 - Balcony door C2**

Results of official tests performed on ENSATEC 244728 and 243212 and on the basis of Annex E of standard EN-14351-1:2006 + A2:2016.

SIDE & CENTRAL CROSS-SECTION

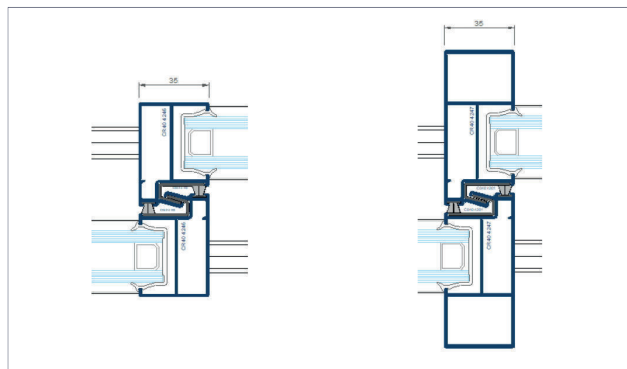
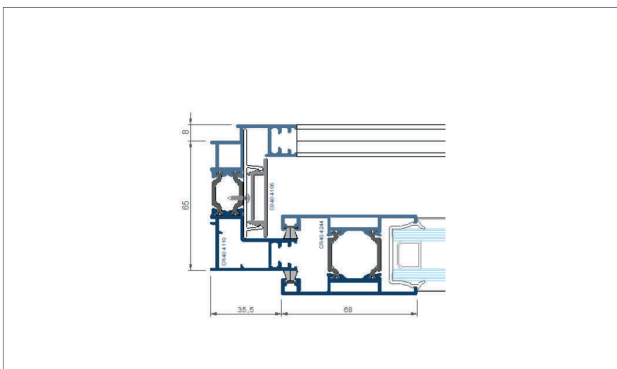

FRAME

Width: 65mm (45° cut)

Thermal break: 24mm

Profile thickness: 1,4mm / 1,6mm

Tracks: 2, 3 or more tracks

SASH

Width: 40mm (straight cut)

Thermal break: 24mm

Profile thickness: 1,4mm / 1,6mm

Hoja ajunquillada: NO

Glass thickness: 14mm mín / 28mm máx.

Maximum weight per leaf: 200 Kg

Maximum permitted dimensions:

Consult at technical office

Possibility of leaf reinforcement

HERRAJES

Multipoint closing: 1, 2, 3, 4 and 5 points

Key multipoint closing

1 point lock

GASKETS AND SEALING

Perimetral and central cross

OPENING POSSIBILITIES

Sliding 2, 3 and more rails

Cierre 90° sin montante vertical

Pocket 1, 2 y 3 sash

STRUCTURES

Windows

Balcony

All components of the **Thermia CR40 VERSIA** system have their origin in the European Union.

ALLOY

6063 T-5 / 6060 T-5

LABORATORIOS



SURFACE FINISHES

Color powder coating in accordance with the QUALICOAT

European certification >60 micras

Available with SEASIDE quality

Wood effect powder coating in accordance with the QUALI-DECO European certification

Anodized in accordance with the QUALANOD European certification > 15 microns available in 20 and 25 microns

Bicolor treatment possibility

