

## ENERGY EFFICIENCY

Estimated acoustic performance up to Rw 39 dB  
Window size: 1.23m x 1.45m with acoustic laminated glass of 4+4.1A/CAM/4+4.1A

## TEST RESULTS

Protection against atmospheric agents

Air permeability: **4**

Water tightness: **9A**

Wind resistance: **C5**

Results of official tests performed on APPLU and on the basis of Annex E of standard EN-14251-1:2006 + A2:2016. N° 16/12260 - 1263 (balcony) / N° 16/12260-1260 (window).

## SIDE & CENTRAL CROSS-SECTION

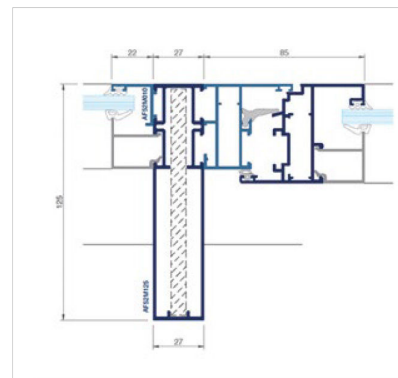
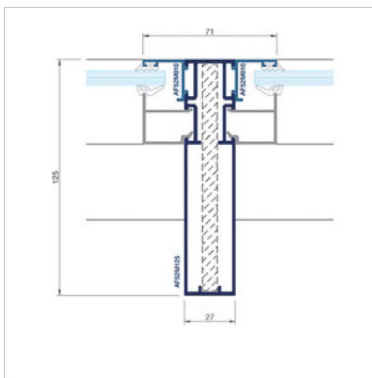

### FRAME

**Width:** 45mm (perimetral cut)

**Thermal break:** NO

**Profile thickness:** 1,5 mm

Same frames for inwards/outwards opening and fixed panel.

### SASH

**Width:** 52 mm

**Thermal break:** NO

**Profile thickness:** 1,2mm / 1,5mm

**Glass thickness:** 4mm mín / 27mm máx.

**Maximum weight:** 160 Kg OB

**Maximum dimension permitted:**

Consult at technical office

### FITTINGS

**Lock:** (door profiles)

**Tilt and turn** (standard and hidden hinge)

**Projecting and hinged**

Motorized system (door frame)

### GASKETS AND SEALING

EPDM perimetral gaskets at leaf

EPDM perimetral frame central gaskets

### OPENING POSSIBILITIES

Casement

Tilt and turn

Projecting

Hinged

Fixed panel

### STRUCTURES

Doors

Windows

All components of the **Thermia AF52 MULLION CE** systems have their origin in the European Union.

### ALLOY

6063 T-5 / 6060 T-5

### LABS



### SURFACE FINISHES

Color powder coating in accordance with the QUALICOAT

European certification >60 microns

Available with SEASIDE quality

Wood effect powder coating in accordance with the

QUALIDECO European certification

Anodized in accordance with the QUALANOD European

certification >15 microns Available in 20 and 25 microns

