

Thermia® CR46 MAGNA

Connect with the outdoors

SERIES FEATURES	
Thermal break	Yes / 24 mm
Main frame	65 mm
Main leaf	46 mm
General thickness of the profiles	1.6 mm
Maximum glazing	34 mm
Maximum leaf weight	300 Kg / leaf
Track option	2, 3 or more tracks
90° frameless "KISS" closure solution	Yes
Available profiles	Window / Balcony Door



	THERMAL	Window $U_w = 1.60 \text{ W/m}^2\text{k}^*$ * Based on EN 10077-02 Balcony Door 3.2 x 2.4 glass $U_g = 1.00 \psi = 0.053$
	ACOUSTICS	Estimated sound attenuation up to Rw 38 dB . Window size: 1.23 m x 1.45 m with acoustic laminated glass of 44.A/cam/44.A

TEST RESULTS

	Air permeability 4
	Watertightness 7A
	Wind resistance Window: C5 Balcony door: C3

Results of test reports at ENSATEC lab, document no. 250712, and based on Annex of standard EN 14351 - 1:2006+A2:2016

CROSS-SECTION

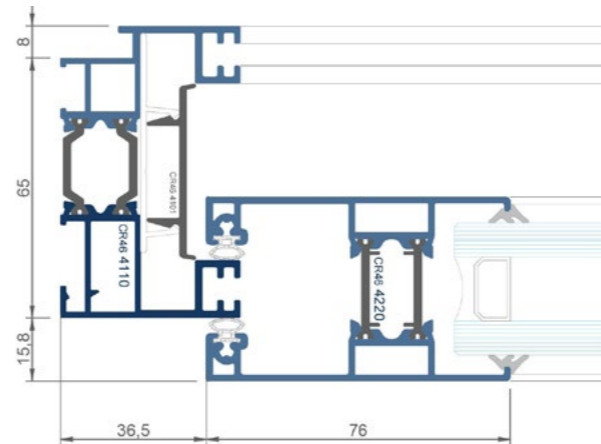

SLIDING / Thermia® CR46 MAGNA

Quality seals



Qualanod seal for anodization
License number: 1014



Qualicoat seal for lacquer
License number: 405



Qualideco seal for imitation wood
License number: ES-0009F

Certification



THERMIA BARCELONA
EN14351-1:2006+A2:2016